

# LORIMER

ESTATE AGENTS



## 30 Grayling Road West Pymble NSW

4 2 2

Enjoying a frontage of approximately 32 meters and situated in one of West Pymble's most sought after locations, this rarely found landholding of 1472sqm over two titles, presents a unique opportunity. Comprising two blocks of 736sqm each, it offers a home and building block with no significant trees. Positioned on a circular driveway, the light-filled, four bedroom family home is ready to enjoy now, yet holds potential to renovate and add value, or demolish and build your dream home or two (STCA). Lifestyle enthusiasts will also enjoy the north south tennis court and saltwater pool.

- Spacious, light filled family home with tennis court and pool
- Four double bedrooms, ensuite to master, plus separate

[For full version visit the website](https://www.lorimerestateagents.com.au)

**Type** : House  
**Price** : \$ 4,500,000  
**Land Size** : 1472 sqm  
**View** : <https://www.lorimerestateagents.com.au/sale/nsw/north-shore-upper/west-pymble/residential/house/7235119>



**Matthew Lorimer**  
0400 844 411



**Lee Duffy**  
0400 844 411

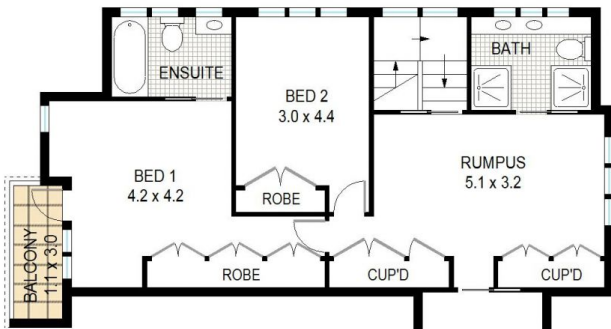

First Floor



Ground Floor

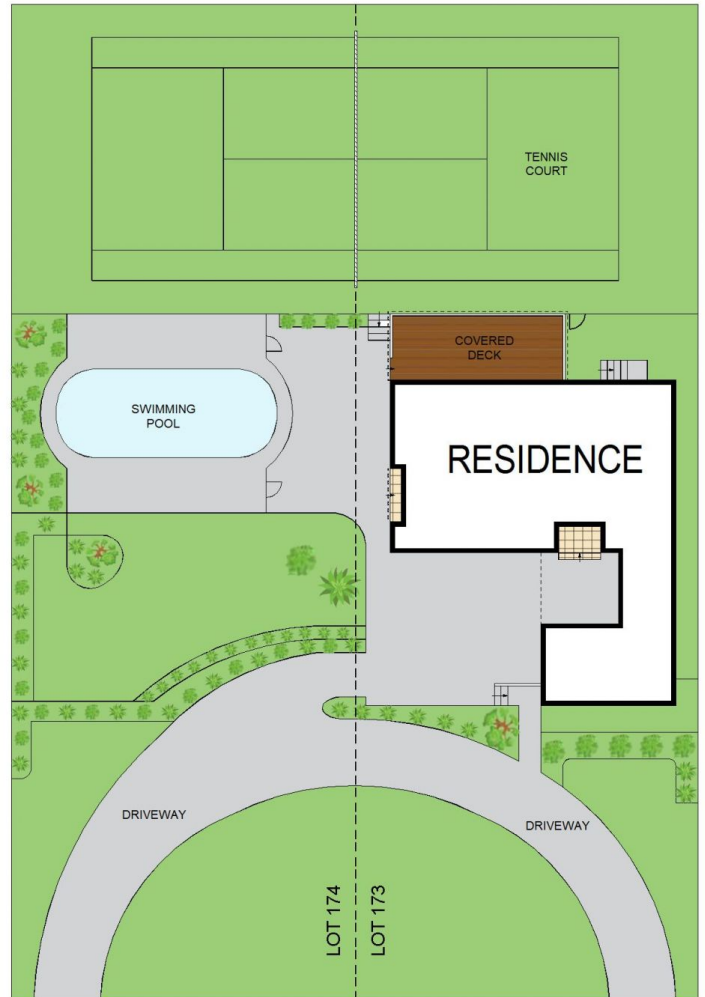

Site Plan

INTERNAL AREA APPROX : 216m<sup>2</sup>

## 30 Grayling Road, West Pymble

Measurements are approximate, Floor plan is indicative only, Floor plan for marketing purposes only